

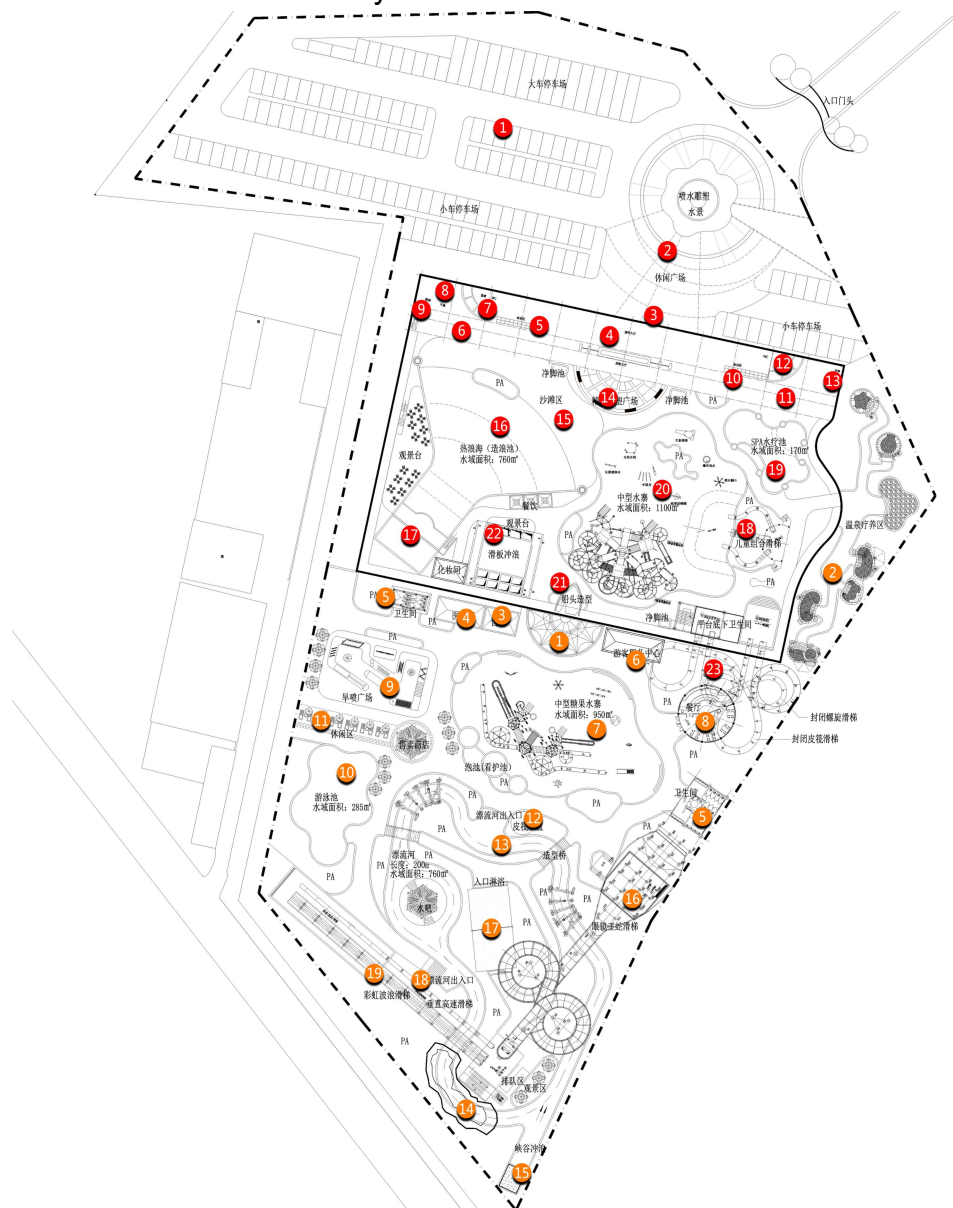

Grand Valley Resorts Water Park

Planned by Vison Waterparks

2015.4.24.88



Indoor waterpark

- 01、 Parking
- 02、 Square
- 03、 Entrance
- 04、 Reception building
- 05、 Women shower
- 06、 Spa
- 07、 Hot spring
- 08、 Sauna
- 09、 Kitchen
- 10、 Men shower
- 11、 SPA
- 12、 Hot spring
- 13、 Sauna
- 14、 Square
- 15、 Beach
- 16、 Wave pool
- 17、 Stage
- 18、 Kids slide
- 19、 Spa
- 20、 Water house
- 21、 Thematic decoration
- 22、 Flower rider
- 23、 Spiral slide

Outdoor water park

- 01、 Square
- 02、 Hot spring spa
- 03、 Store
- 04、 Infirmary
- 05、 Toilet
- 06、 Service center
- 07、 Water house
- 08、 Restaurant
- 09、 Fountain
- 10、 Swimming pool
- 11、 Rest area
- 12、 Slide
- 13、 Lazy river
- 14、 Cave
- 15、 Artificial flood
- 16、 Cobra slide
- 17、 Beach Volleyball
- 18、 Free fall slide
- 19、 Rainbow slide

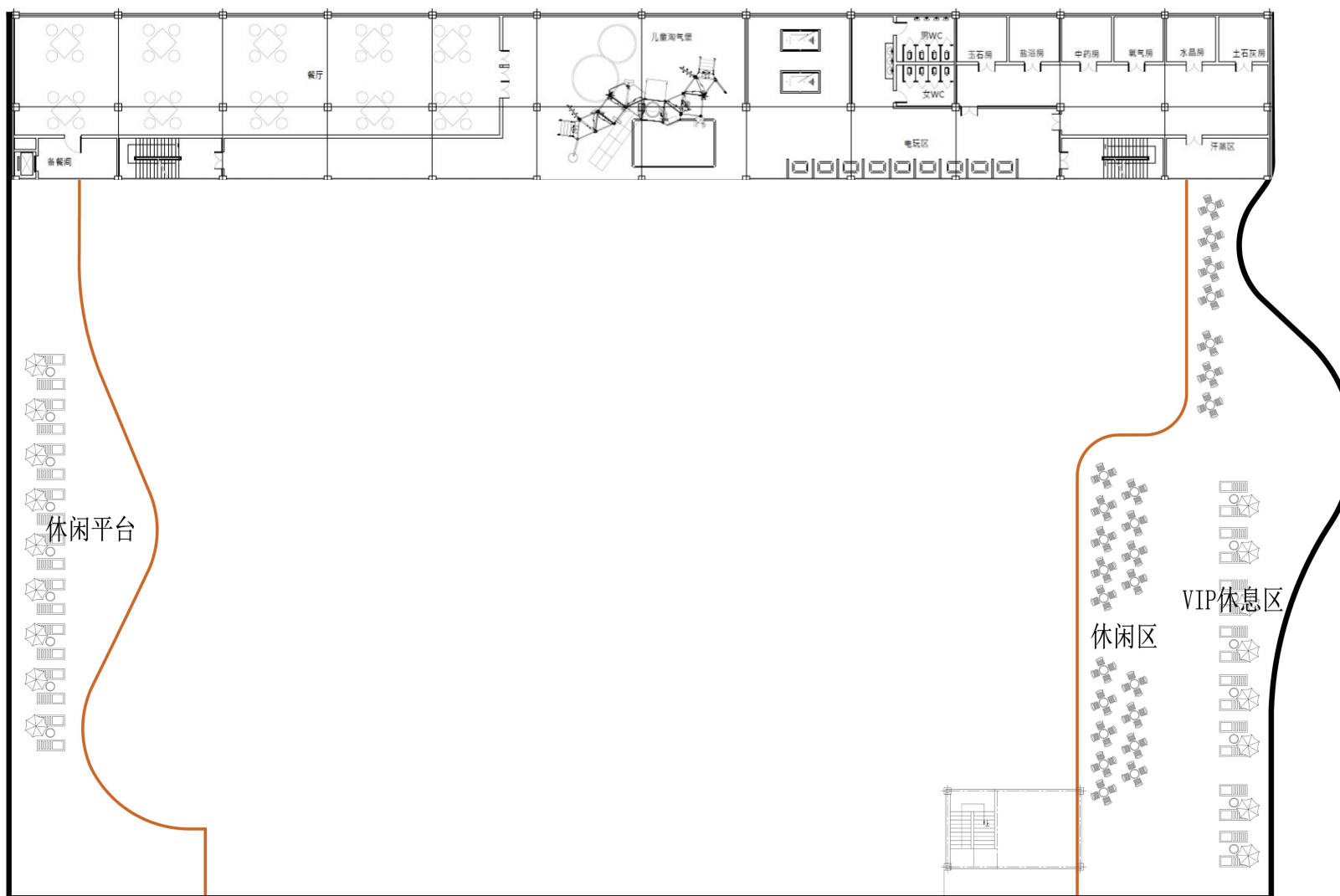



Concept design for reference



Index:

- | | |
|-----------------|---------------------------------|
| 01、 Parking | 15、 Outdoor Spa |
| 02、 Fountain | 16、 Water house |
| 03、 Reception | 17、 Fountain for kids |
| 04、 Square | 18、 Swimming pool |
| 05、 Beach | 19、 Lazy river |
| 06、 Wave pool | 20、 Beach volleyballs |
| 07、 VIP suite | 21、 Rainbow and free fall slide |
| 08、 Stage | 22、 Cobra slide |
| 09、 Flowrider | 23、 Artfical flood |
| 10、 Water house | |
| 11、 Kids games | |
| 12、 Kids slide | |
| 13、 Spa pool | |
| 14、 Slide | |



序号No.	项目Item	面积Sqm	备注Remark
1	停车场Parking	19000sqm	Around 500 cars
2	室内水世界Indoor waterpark	Area 5824sqm, total available area 10160sqm	Building size: 91mx64m, Height: 18m
3	室外水世界Outdoor waterpark	20972 sqm	
4	设计总面积Total area	50132 sqm	









Infinite swimming pool



Water bar

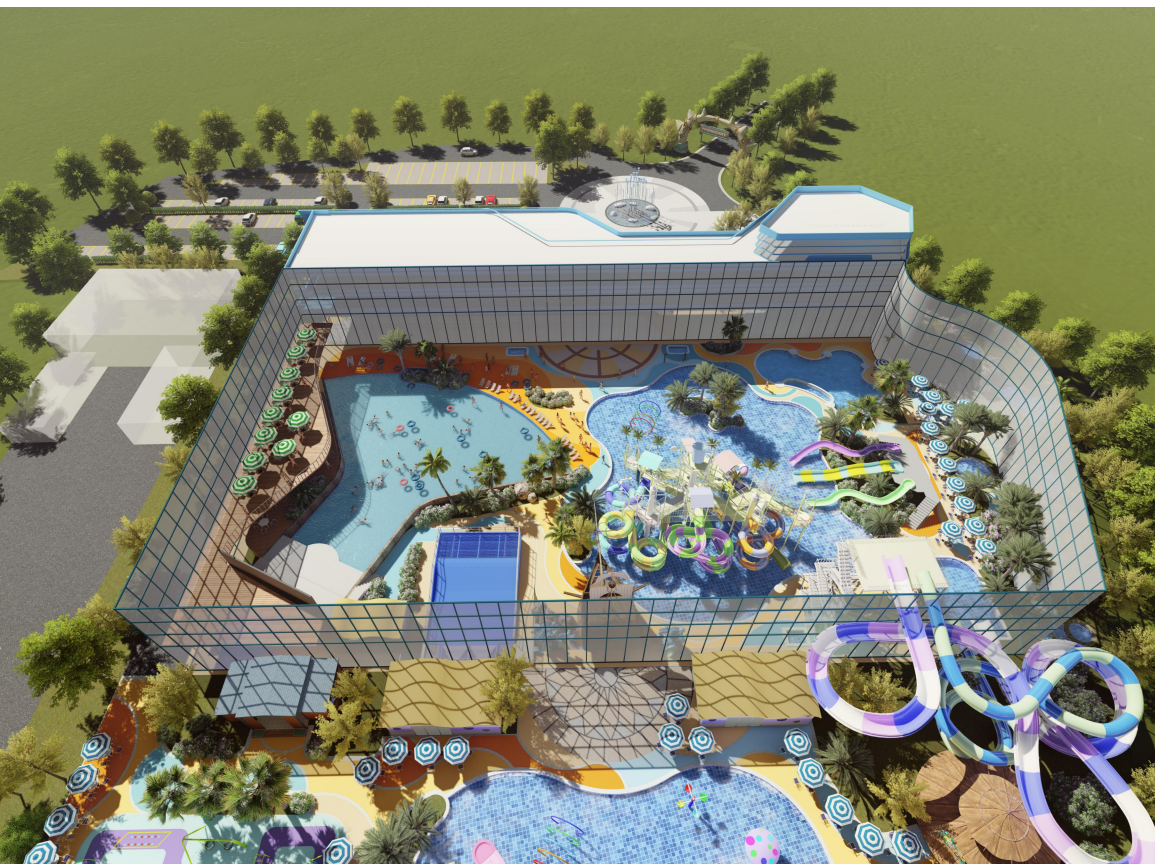

Indoor water park



Outdoor water park



热带岛上沙滩排球3D效果图

Indoor Waterpark

In the long autumn, winter and spring seasons, especially in winter, outdoor tourism projects are scarce, and South Africa's Grand Valley Resorts Water Park can provide local and surrounding citizens with a destination where they can play all day, with everything to eat, drink, play and have fun. Tourists of all ages can find the items they want to play:

Children, there are water toys, water villages, surf pools, naughty castles, fountains, etc.;

Teenagers, there are video games, water slides, skateboarding, cinemas, etc.;

For adults, there are surf pools, saunas, massages, mini bars, billiards, chess and cards, etc.;

For the elderly, there are rubbing baths, wave pools, spa pools, saunas, etc.;



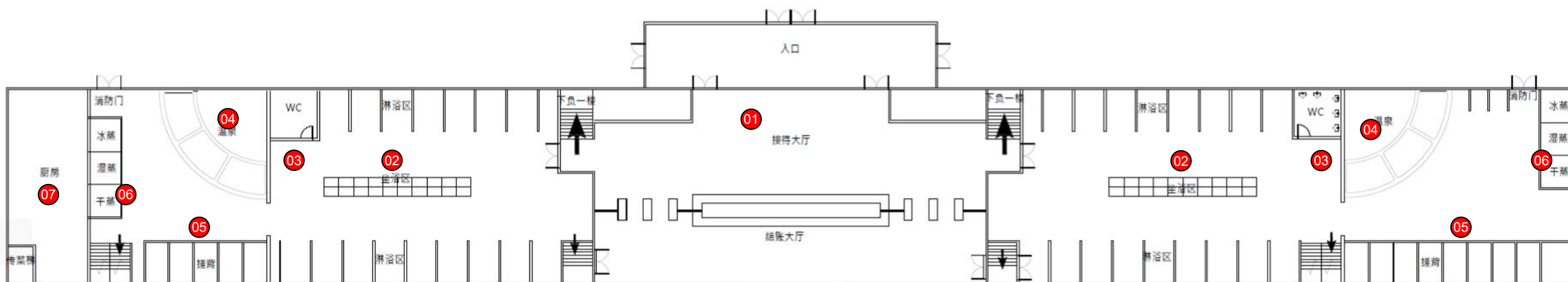

Index:

- 01、 Reception
- 02、 Shower
- 03、 Toilet
- 04、 Spa pool
- 05、 Washing area
- 06、 Sauna
- 07、 Kitchen

First floor plan design

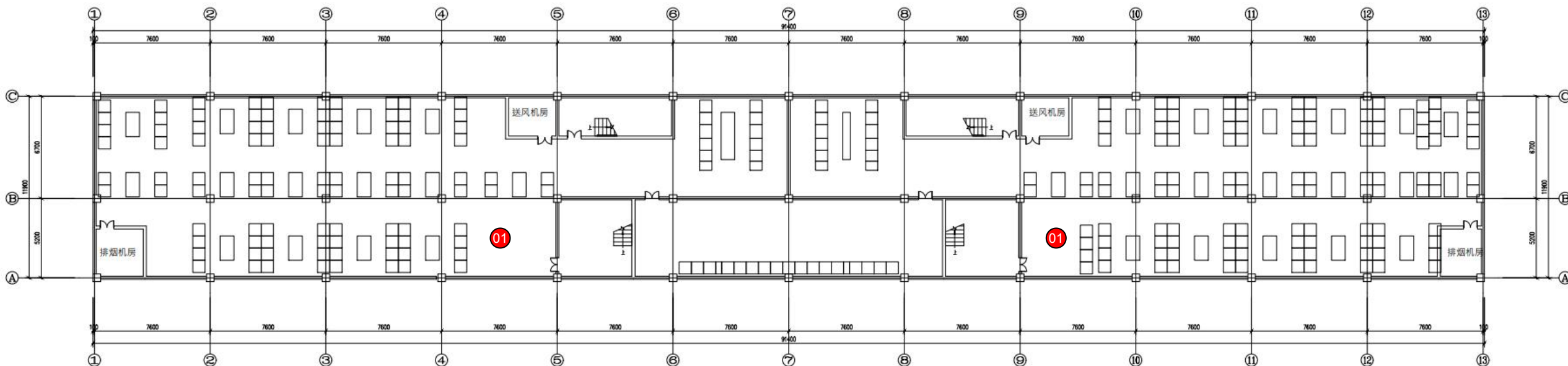

Index:

01、Locker and changing room

Ground floor plan design

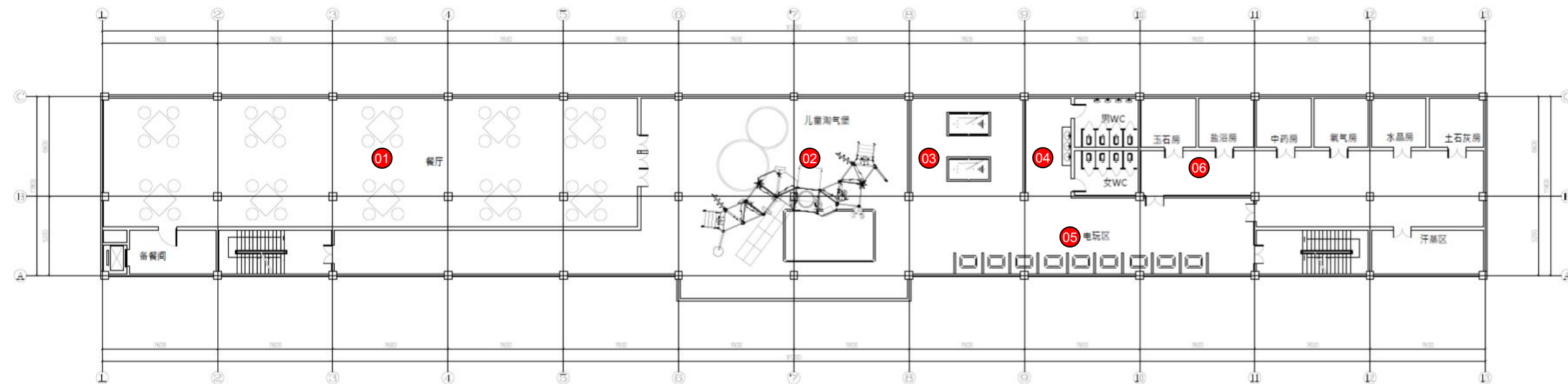

Index:

- 01、 Restaurant
- 02、 Playground
- 03、 Billiards
- 04、 Toilet
- 05、 Electric games
- 06、 Sauna

Second floor plan design

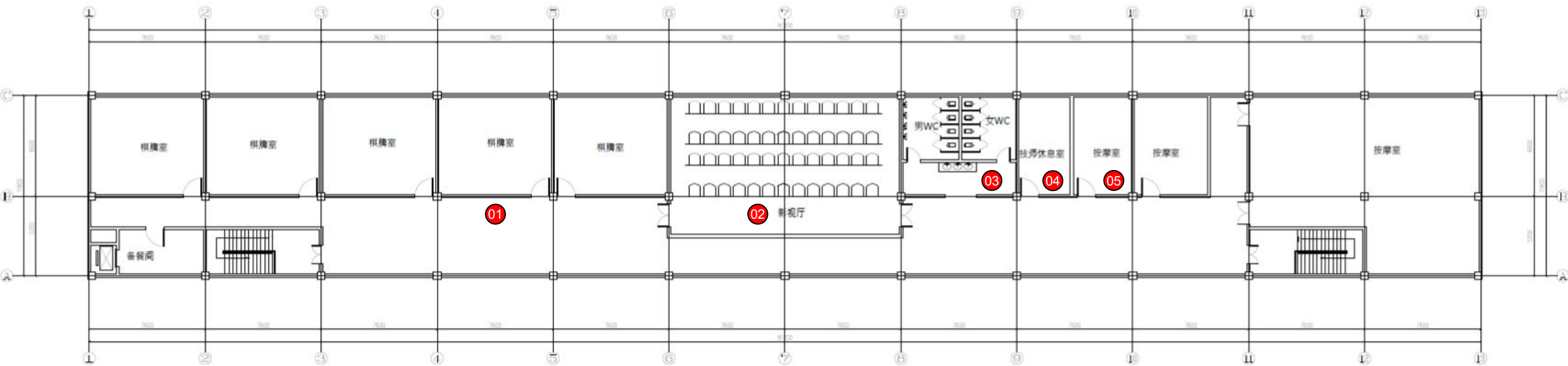

Index:

- 01、Chess Room
- 02、Cinema
- 03、Toilet
- 04、Rest room for worker
- 05、Massage room

Three floor plan design



Shower



Locker

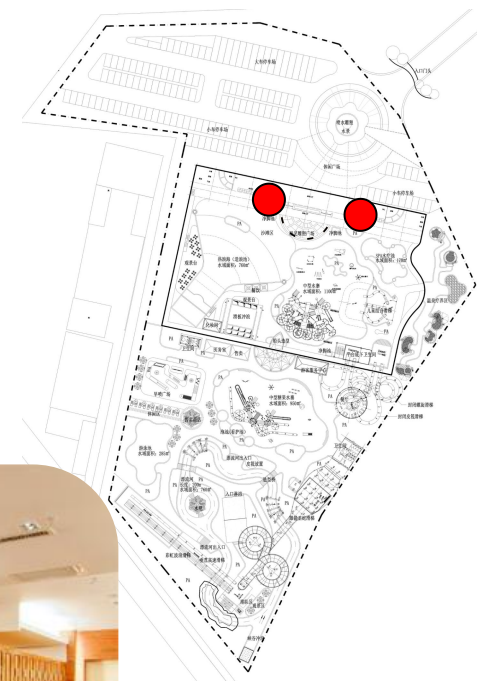



SPA pool



Massage



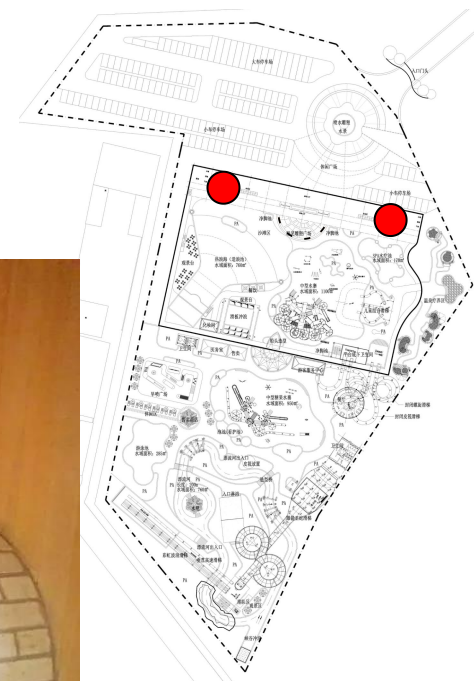
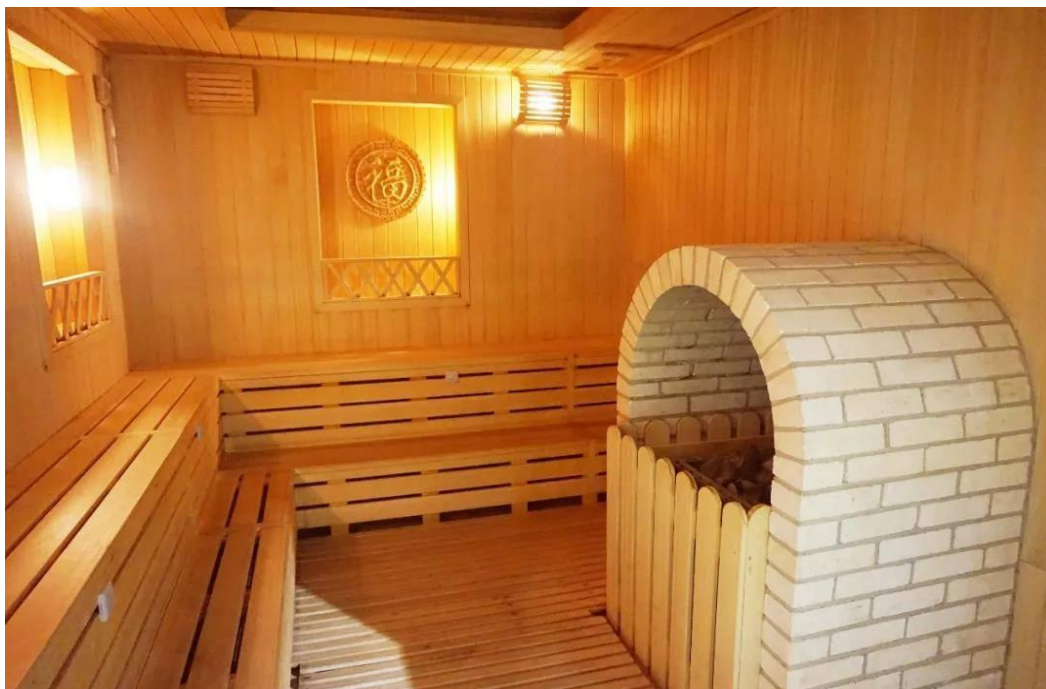

Sauna

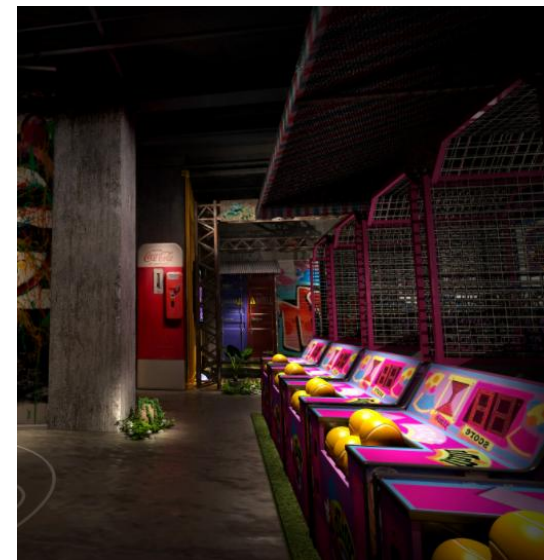



Billiards





Playground in #2 floor





Cinema





Massage room



Table football

Equipment introduciton

2015.4.24.88



Kids slide



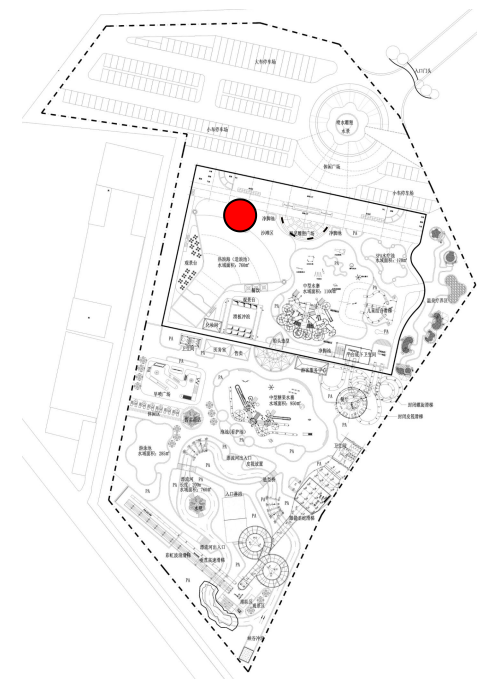

Beach area: 250m²



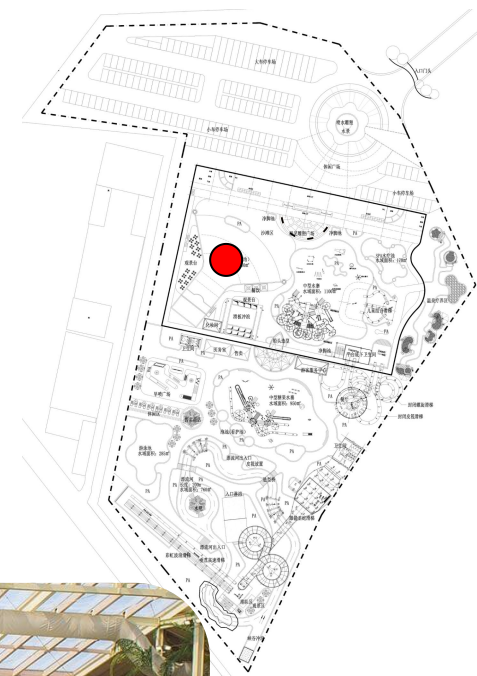

Wave pool area:900m², can contain over 300 visitors, max:800 visitors.



Double flowrider





Close body slide height:11m,width:1m, Length:99m; Close inflatable tube slide height:11m,width:1.4m,length:151m

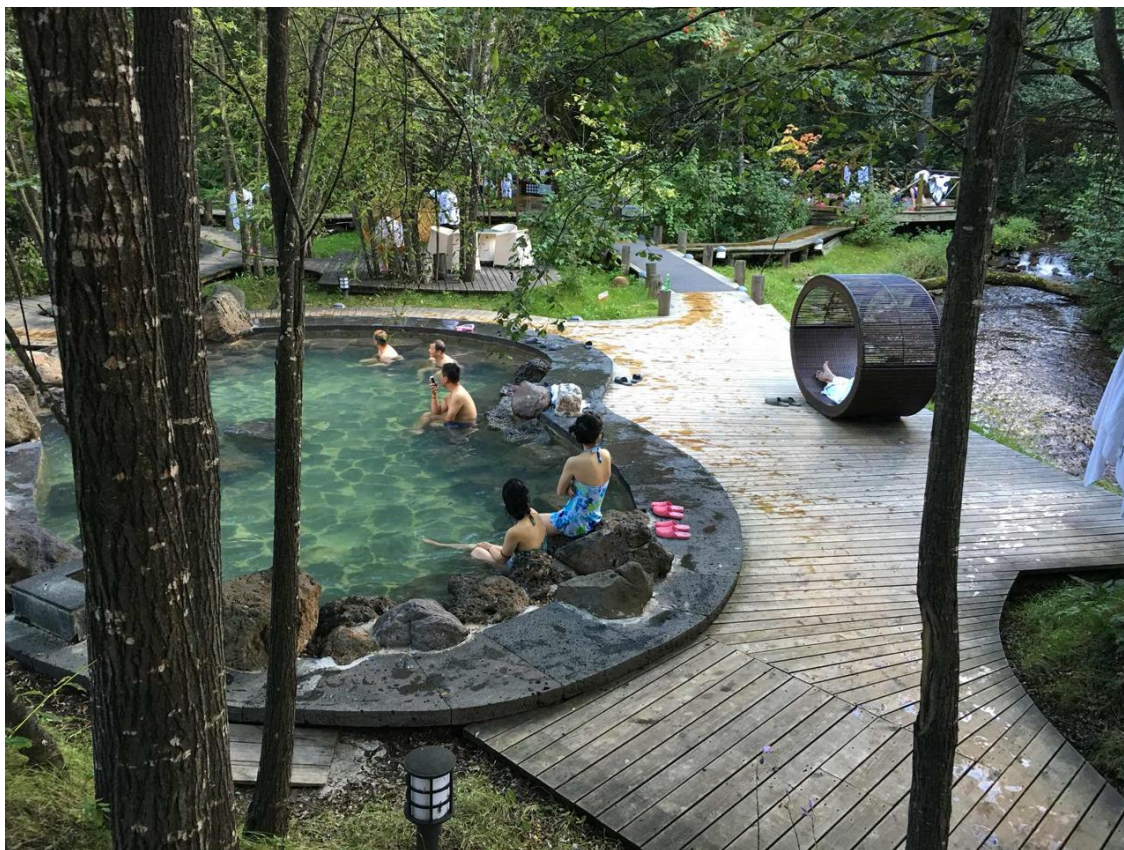

Outdoor spa pool

Outdoor Waterpark

Outdoor play items are mainly king cobra slides, rainbow slides, lazy rivers, standard swimming pools, restaurants, children's water villages, children's interactive fountains, sand pools, adult bubble pools, and leisure areas.

In summer, the entire project can be opened, and there is enough space to hold various performances and team building activities to increase the number of tourists; in winter, the outdoor area is closed to save energy.

3D concept design





Water house pool: 970m², size: 470 m²

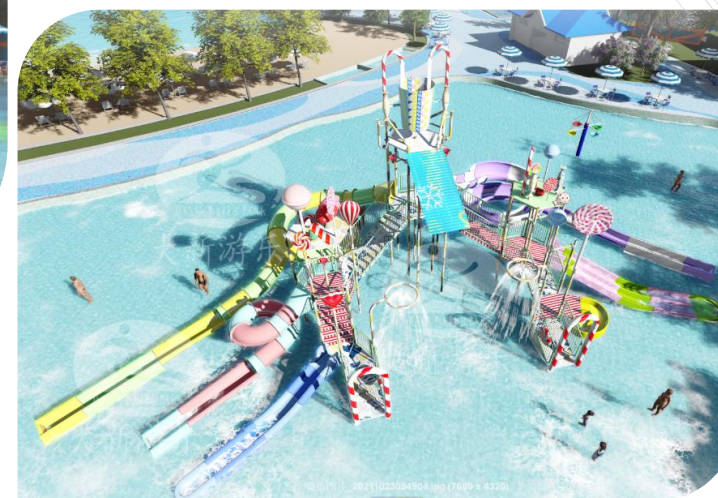
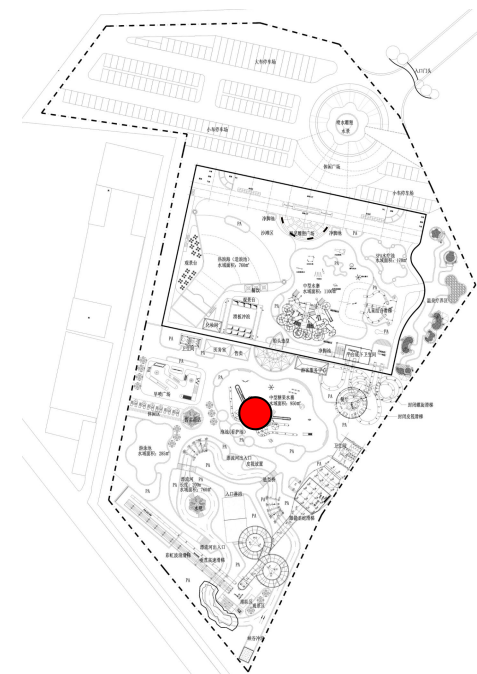



Kids games



Swimming pool

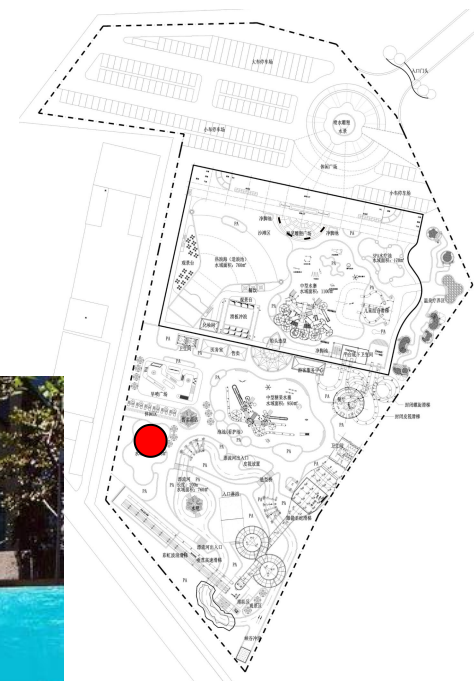



Rainbow slide: 12m, length:94m



Free fall slide height: 10m, Length:56m





Water bar around the lazy river

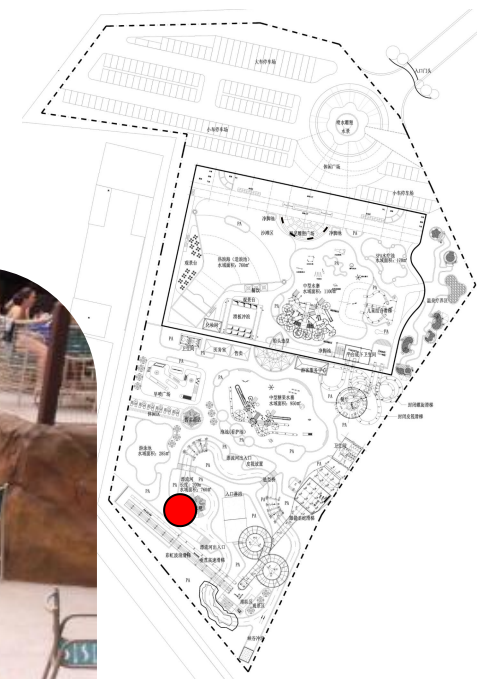

Lazy river: 230M, width: 3M, t here is island in the center, visitor could enjoy a nice view around river.



Artificial flood



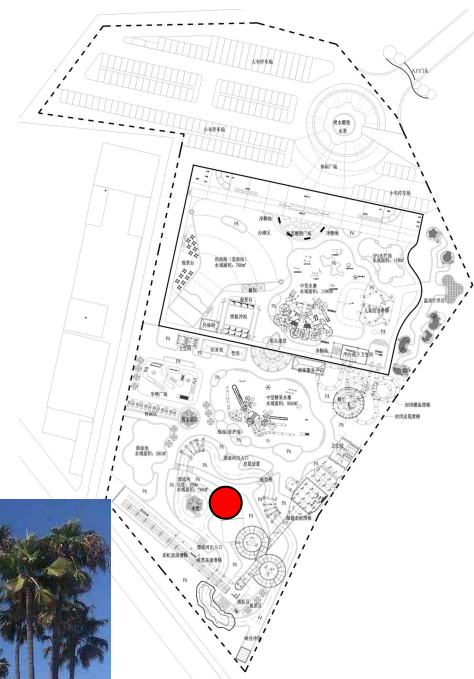

Beach volleyball is indispensable for tropical beach islands. We set up children's sand pools and beach volleyballs on the island. You don't have to go to Sanya to surf and play in the sand.

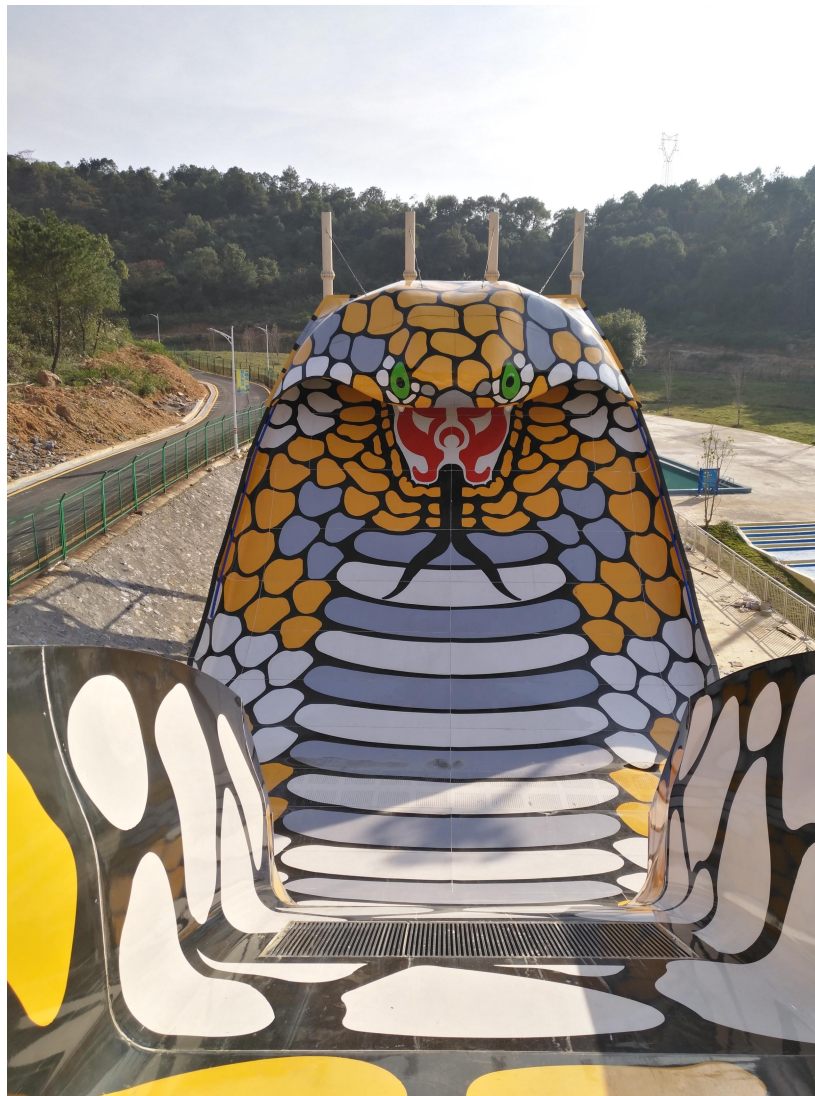
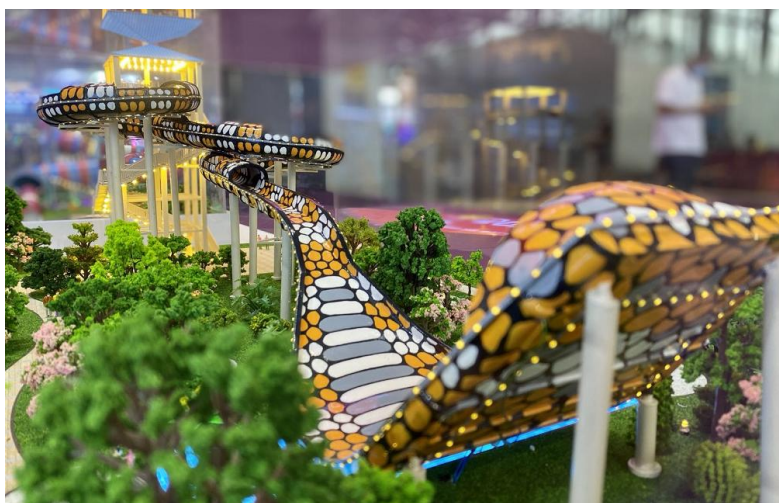
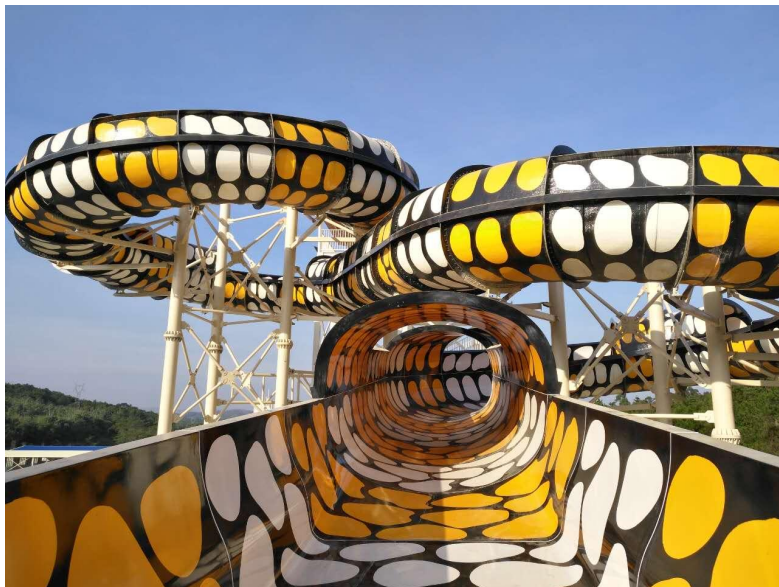

Height: 18m
Length: 130m

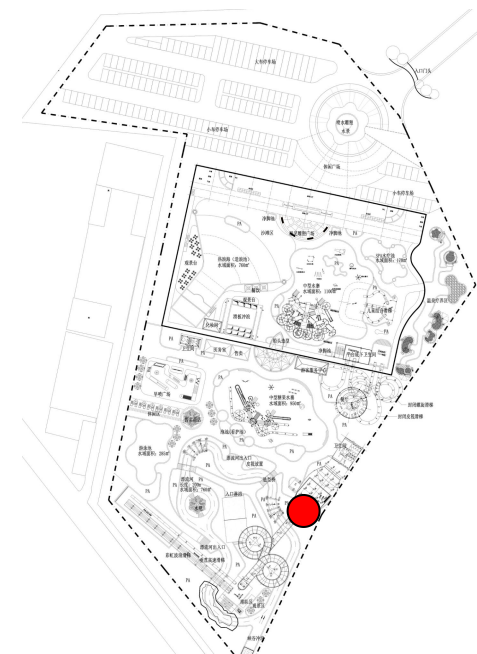





Outdoor store



序号 No.	季节 Season	门票类型Type	人数Capacity Quantity/day	门票价格Ticket (USD)	金额Amount
1	Summer	Weekend and holiday	5000	20	
2		Working days	1000	15	
3		Group		80	
3	Winter	Weekend and holiday	1200	15	
4		Working days	400	10	
3		Group		10	



韦森荣 Kevin Wei

Mob手机: +86 139 22323263 Tel电话: +86 20 8476 1233

Email邮箱: kevintrendgroup@163..com

Address: Room 108, No. 263 Xingye Avenue East, Panyu District, Guangzhou,Guangdong, PRC.

广东省广州市番禺区南村镇兴业大道东263号升海创意产业园

Factory address

Tel: +86 147 4810 8508

0086-20-39957689

www.waterpark-equipment.com www.visonwaterparks.com

